

Confidential Lamp Specification Sheet

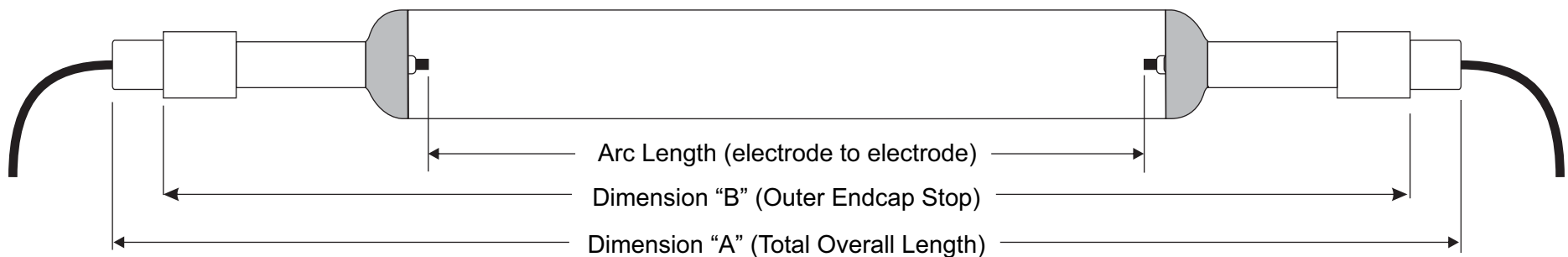

Customer	System Name	
Customer #	Ballast Type	EER #
Miltec Rep	Order Pending	Date Submitted



Lamp Manufacturer	Miltec Part #
Manufacturer Part #	Miltec Cross#

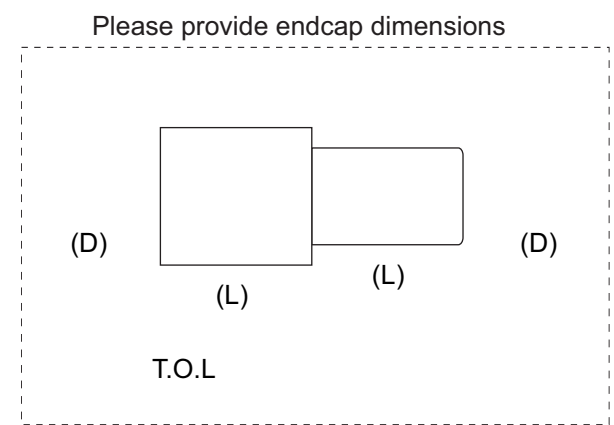

PHYSICAL CHARACTERISTICS

Electrical Characteristics

Type

Mercury	Gallium	Iron	Unknown
---------	---------	------	---------

Arc Length

T.O.L. (Dim. "A")

OES (Dim. "B")

Lamp Voltage

Lamp Current

WPI (watts per Inch)

Open Circuit Voltage

WIRE TERMINATION

Wire Lead Length (Left)	Ring Terminal	Fork Terminal	Male Disconnect	Female Disconnect
Wire Lead Length (Right)	#8	#8		
Wire Lead Termination	#10	#10	Ferrule	Bare Wire
Quartz Diameter (mm)	1/4"	1/4"	Pin	Metal Ends

Confidential Lamp Specification Sheet

Service Dept. Use Only

Date Tested by Service

Service Technician

Ballast Tap Setting (V)

Capacitance (μF)

Lamp S/N